

4

3

2

1

REVISIONS				
ZONE	REV.	DESCRIPTION	DATE	APPROVED
	1	TO BE RELEASE	11/15/2022	OBM

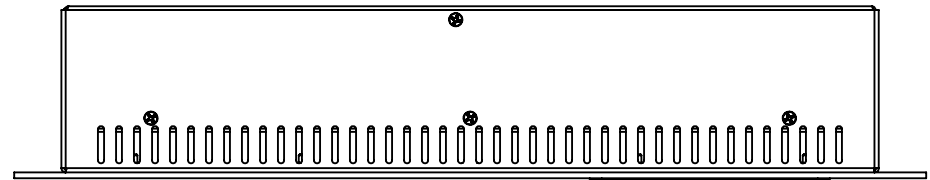

B

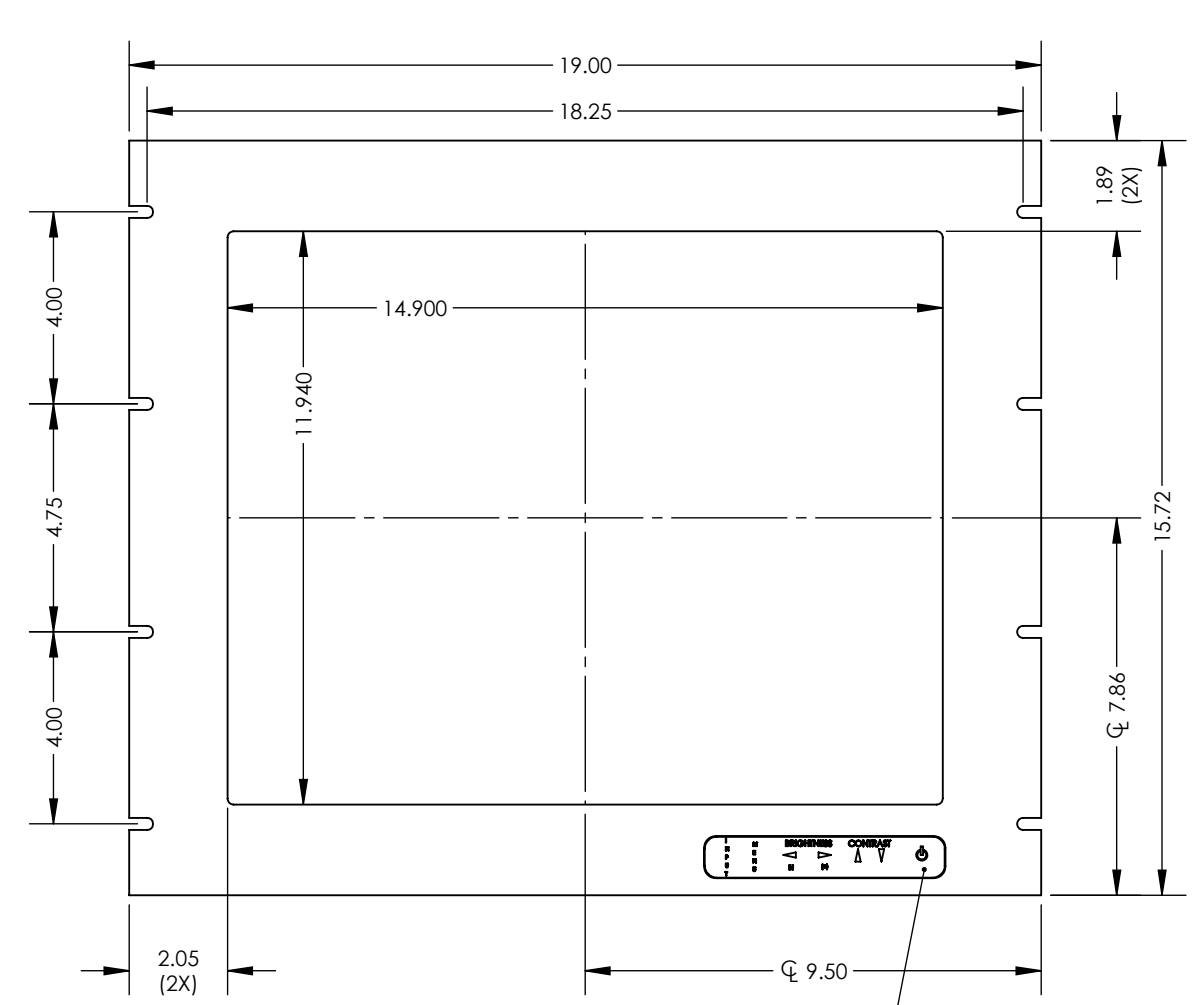

FRONT CONTROLS
OSD MEMBRANE SWITCH

VESA MOUNT
75/100

OPTIONAL REAR CONTROLS
OSD MEMBRANE SWITCH

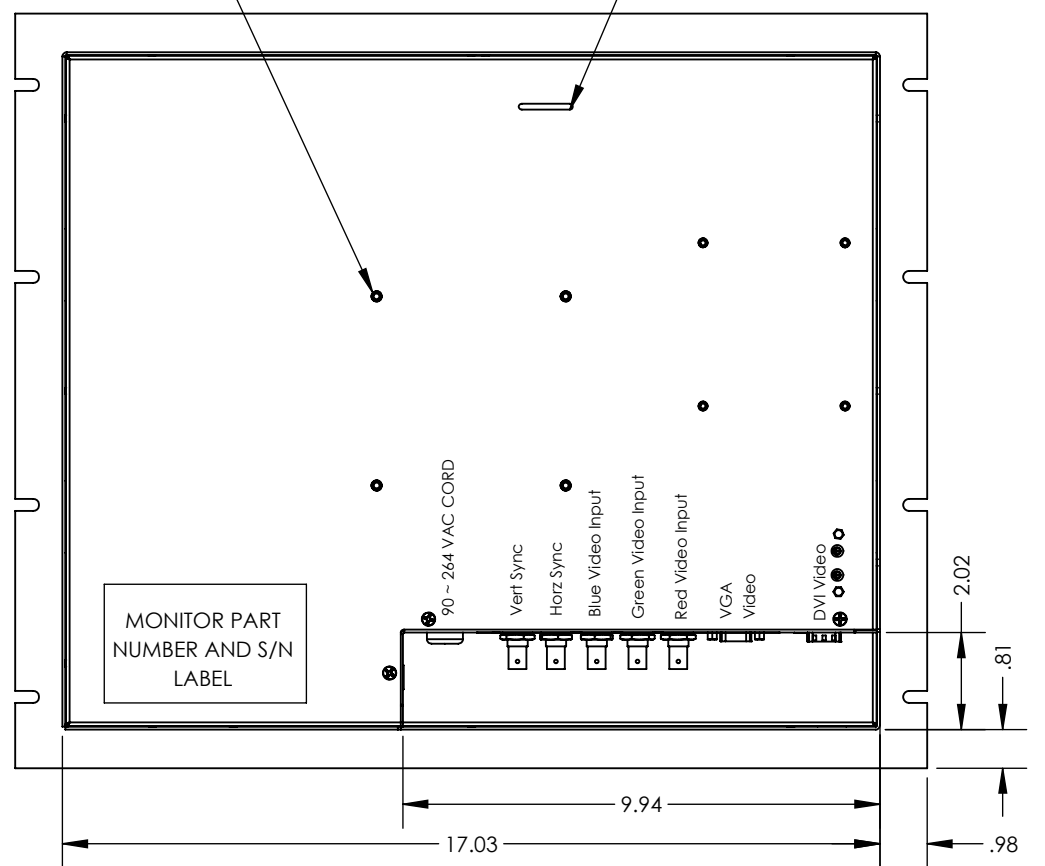

NOTES:

- MONITOR WEIGHT : 23.5Lb.
- MONITOR FINISH: BEZEL -BLACK EPOXY POWDER / WRINKLE FINISH, REAR CHASSIS CLEAR ZINCK PLATED.

A

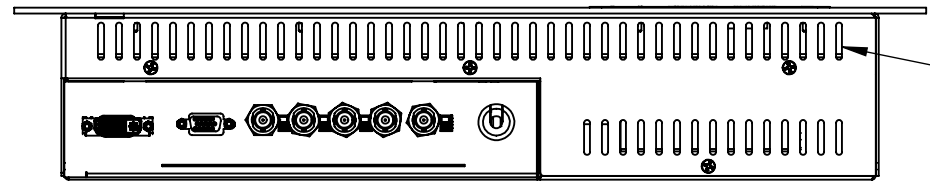

CONNECTOR AREA.
CONSOLE MUST
ALLOW ACCESS AND CLEARANCE

AIR EXHAUST ALL SIDES
DO NOT BLOCK AIR FLOW

PROPRIETARY AND CONFIDENTIAL
THE INFORMATION CONTAINED IN THIS DRAWING IS THE SOLE PROPERTY OF DYNAMIC DISPLAY, INC. ANY REPRODUCTION IN PART OR AS A WHOLE WITHOUT THE WRITTEN PERMISSION OF DYNAMIC DISPLAY, INC. IS PROHIBITED.

UNLESS OTHERWISE SPECIFIED:		NAME	DATE
DIMENSIONS ARE IN INCHES	DRAWN	OBM	11/15/2022
TOLERANCES:	CHECKED	DR	11/15/2022
FRACTIONAL ±	ENG APPR.	OBM	11/15/2022
ANGULAR: MACH ± BEND ±.5°	MFG APPR.	TJP	11/15/2022
TWO PLACE DECIMAL ±.020	Q.A.	MRC	11/15/2022
THREE PLACE DECIMAL ±.010	COMMENTS:		
INTERPRET GEOMETRIC TOLERANCING PER:			
MATERIAL			
FINISH			
DO NOT SCALE DRAWING			

Dynamic Displays, Inc.

TITLE: **OUTLINE DWG, 19" RACK VGA-BNC-DVI, COLOR**

SIZE	DWG. NO.	REV
B	0014177	1

SCALE: 1:4 SHEET 1 OF 1

4

3

2

1

B

A